

<b>Explosion protection:</b>	<b>II2G Ex d e mb IIC T6 Gb</b> <b>II2D Ex tb IIIC T75°C Db IP66</b>
<b>Ingress protection:</b>	<b>IP66</b>
<b>EC Type certificate:</b>	<b>CEC 15 ATEX 176</b>
<b>Ambient temp.:</b>	<b>-20°C ÷ +40°C/+60°C</b>
<b>Body:</b>	<b>Light alloy with powder coating</b>
<b>Diffuser:</b>	<b>Borosilicate glass</b>
<b>Metal parts:</b>	<b>Stainless steel</b>
<b>Lamp socket:</b>	<b>G13 for T8 tubes</b>
<b>Light source:</b>	<b>LED, 120°, 5.500K</b>
<b>Power supply:</b>	<b>230Vac 50/60Hz ±10%</b> <b>Other voltages on request</b>
<b>Back-up:</b>	<b>Ni-Cad Cells 3.6V</b> <b>1 Hr autonomy (3 Hr on request)</b>
<b>Connection:</b>	<b>3 Pole connection block 2.5mm<sup>2</sup></b>
<b>Cable entries:</b>	<b>2 Entries ¾" Gk</b>

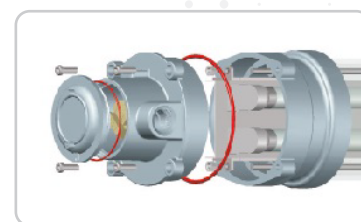
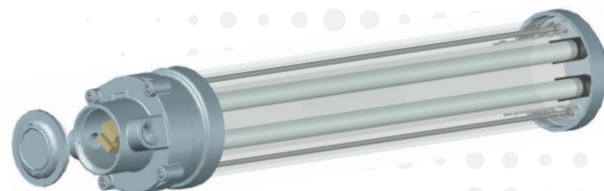

## SELECTION CHART

Article code	Normal operation		Emergency operation		Dim A [mm]	Dim B [mm]	Dim C [mm]
	Power rating	Luminous Flux	Power rating	Luminous Flux			
BTL 15 RUN 240	1 x 17 W	1.800 lm	-	-	745	585	130
BTL 215 RUN 240	2 x 17 W	3.600 lm	-	-	745	585	130
BTL 30 RUN 240	1 x 35 W	3.600 lm	-	-	1.345	1.185	130
BTL 230 RUN 240	2 x 35 W	7.200 lm	-	-	1.345	1.185	130
BTL 40 RUN 240	1 x 44 W	4.500 lm	-	-	1.645	1.485	130
BTL 240 RUN 240	2 x 44 W	9.000 lm	-	-	1.645	1.485	130
BTLE 15 RUN 240	1 x 17 W	1.800 lm	4 / 13 W	550 / 1.300 lm	745	585	130
BTLE 215 RUN 240	2 x 17 W	3.600 lm	4 / 13 W	550 / 1.300 lm	745	585	130
BTLE 30 RUN 240	1 x 35 W	3.600 lm	4 / 13 W	550 / 1.300 lm	1.345	1.185	130
BTLE 230 RUN 240	2 x 35 W	7.200 lm	4 / 13 W	550 / 1.300 lm	1.345	1.185	130
BTLE 40 RUN 240	1 x 44 W	4.500 lm	4 / 13 W	550 / 1.300 lm	1.645	1.485	130
BTLE 240 RUN 240	2 x 44 W	9.000 lm	4 / 13 W	550 / 1.300 lm	1.645	1.485	130
BTLEE 15 RUN 240	-	-	4 / 13 W	550 / 1.300 lm	745	585	130

## DIMENSIONAL DRAWING

FIG A

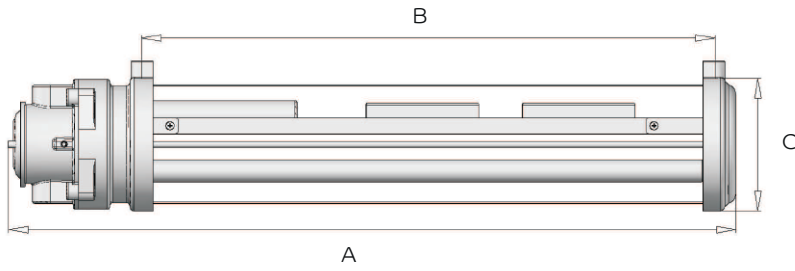

## INSTALLATION AND MOUNTING BRACKETS

### WALL / CEILING MOUNTING

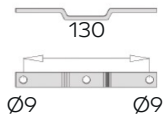

### POLE MOUNTING

